

Jeep												
Wrangler	07	08	09	10	11	12	13	14	15	16	17	18

- This remote start will monitor the vehicle lock circuit and use the pulses generated by pressing lock 3 times on your OEM remote to start the vehicle.
- This is a pre-wired plug and play kit and all the required connections have been made within the harness.
- We have already loaded the correct firmware into the remote start module. You will need to pair the module to your key when the installation is complete. Instructions begin on page 4.

7

There are 5 basic steps to this remote start installation. We're going to address each of these:

1. Prepare the vehicle
2. Make your wiring connections
3. Pair the remote start to the vehicle
4. Test the system
5. Button it up!

- Where Everything Goes

Remote Start Module – the wiring for the module is done under the dash on the driver's side, so you'll want to install the module in that general area. Before you start wiring, look for a location where there's some open space that will fit the module. Pay attention to moving parts like the pedals, e-brake and steering column. Be sure to route your wiring away from those areas.

STEP 1: Prepare the Vehicle

Begin by removing the plastic shroud below the steering wheel and then the plastic around the steering wheel column. Remove the three screws and loosen the tilt lever and pull lower plastic panel down. Be careful not to break the panel –especially in cold weather.

Step 2: Make the Connections

The T-Harness will have some plugs on the other end. This is what you do with them:

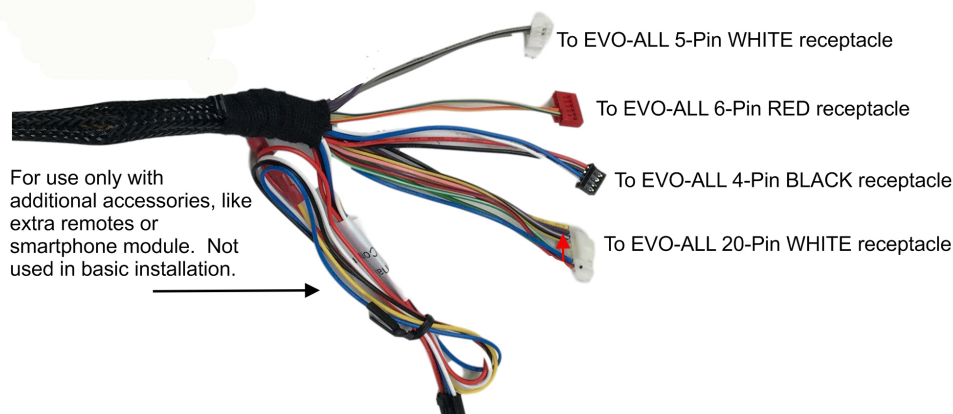

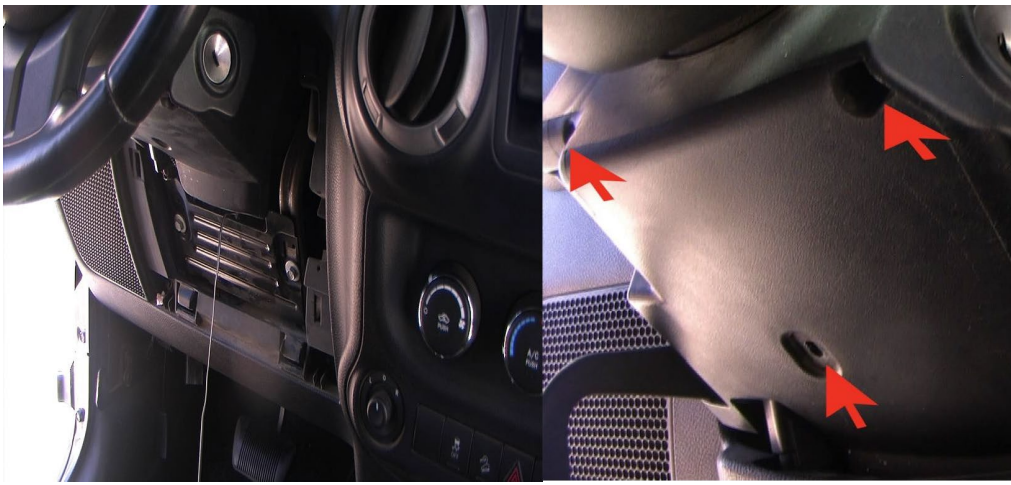

Production Change Mid 2016:

Some 2016 and all 2017 models have a lip that goes under the steering wheel. You must push the panel forward to remove it. Use a plastic scraper or pry tool to wedge inbetween the steering wheel and the steering wheel cover to get the lip around the corner so you can pull it down and remove it without removing the steering wheel. See below.



Locate the immobilizer connector at the bottom of the key cylinder (see pictures below). Carefully disconnect the connector and insert the male plug from the T-harness in its place. Then plug the vehicle immobilizer connector in to the T-harness female connector. **Caution: Be careful when disconnecting the harness from the immobilizer connector in the vehicle. It is very fragile and will break if too much force is used. Kleinn is not responsible for any damage caused by improper removal of the connector.**

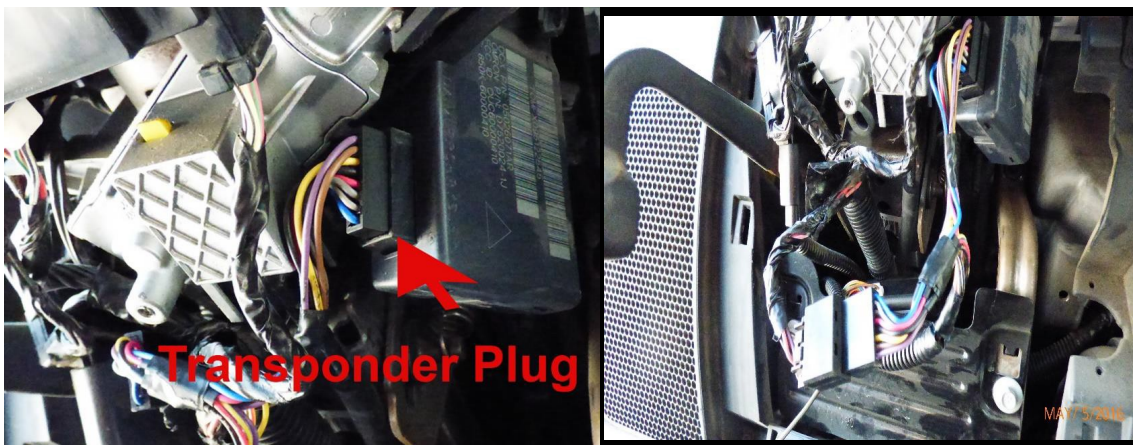

System Wiring Diagram

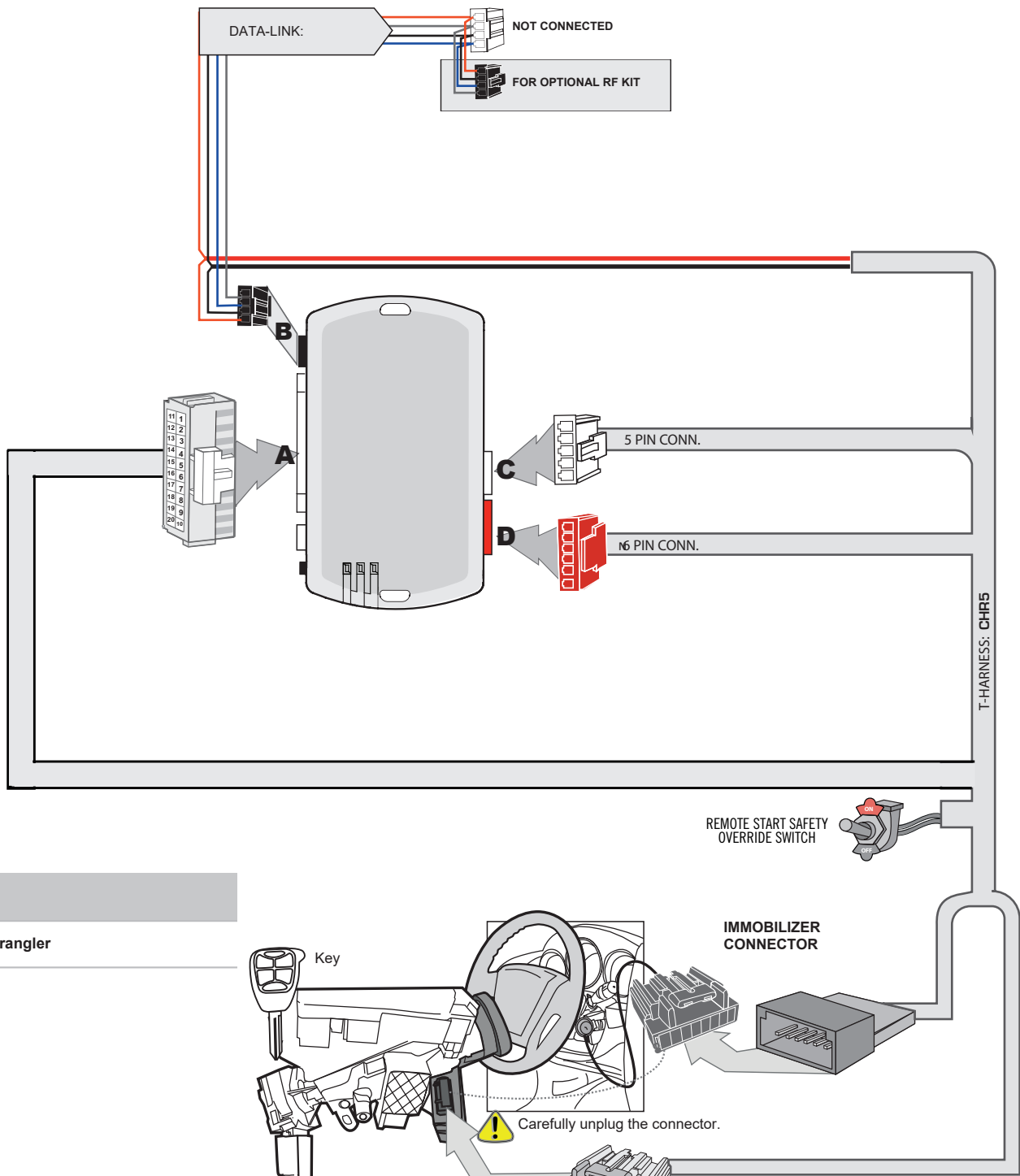

Wrangler

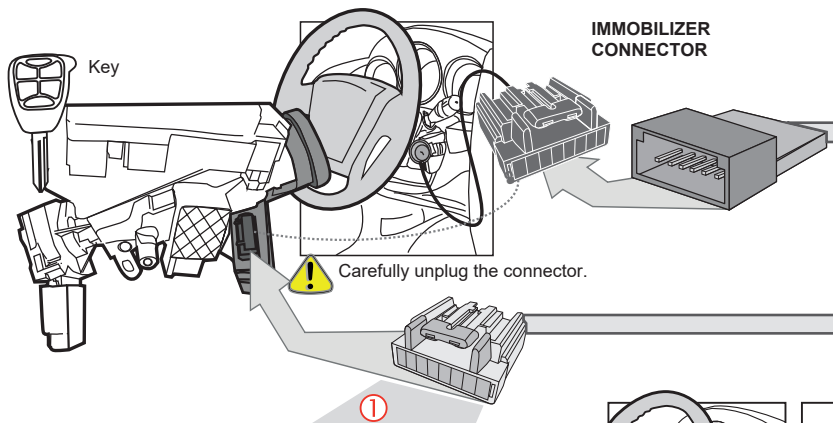

Vehicle transponder connector
Back view

CAUTION
TAKE CARE WHEN DISCONNECTING THE HARNESS FROM THE IMMOBILIZER CONNECTOR. IT IS VERY FRAGILE AND CAN EASILY BREAK.

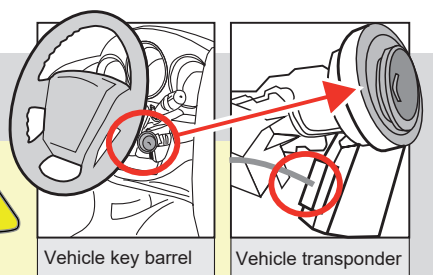

STEP 3: Programming

Once the T-harness has been plugged in to the vehicle, the remote start module is ready to be programmed. Begin with all plugs disconnected from the remote start brain, then perform the programming steps below:

1

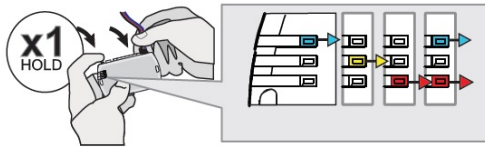

Press and hold the programming button:
Connect the 4-PIN Data-link harness (Black connector).

↳ The Blue, Red, Yellow and Blue & Red LEDs will alternatively illuminate.

2

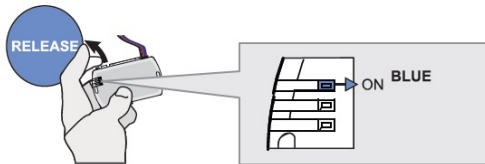

Release the programming button when the LED is BLUE.

If the LED is not solid BLUE disconnect the 4-Pin connector (Data-Link) and go back to step 1.

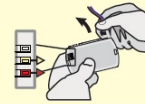

3

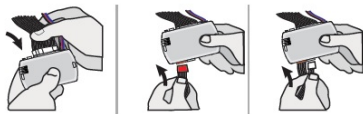

Insert the required remaining connectors.

4

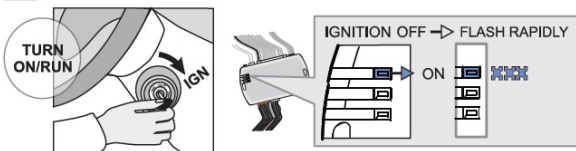

Turn the key to the Ignition ON/RUN position.

↳ The BLUE LED will flash rapidly.

5

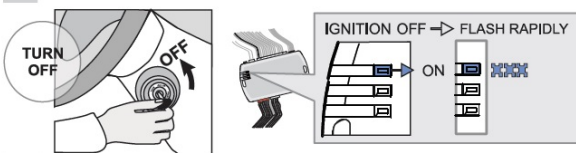

Turn the key to the OFF position.

↳ The BLUE LED will flash rapidly.

6

With OEM remote



Press the LOCK button on the vehicles OEM remote.

Or

Without OEM remote



Press and release the programming button on the module once.

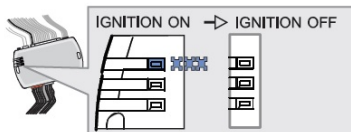

↳ The BLUE LED will turn off.



The module is now programmed.

Use the remote of the remote starter or security system to test all of the supported features to ensure proper programming.

Step 4: Test the System

Once all wiring and programming are done, you should test the system to make sure everything is working properly before you close up the installation.

①



LOCK 3X

Press the lock button on the OEM remote three times in a row to activate the remote starter.

The vehicles ignition/accessory circuits will turn on after a few seconds. Another few seconds later the starter motor will engage. It's all about getting the timing down. Lock-1000-Lock-1000-Lock. You will see the Blue light on the remote start module every time you press the Lock button.

②



Step on the brake pedal to stop the engine.

REMOTE STARTER FUNCTIONALITY



All doors must be closed.



Remote start the vehicle.

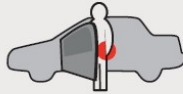

Unlock door with remote or key and enter the vehicle.

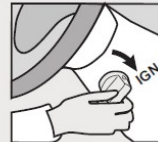

Insert the key into key switch and turn the key to the on/run position



You may now press the brake to shift into gear and drive the vehicle.

Step 5: Close it Up

Now gather up all of your wiring and neatly bundle it together using zip ties or electrical tape. Find a secure place to put the remote start module and use zip ties to secure it. **Make sure that the remote start wires are not near any moving parts on the steering wheel, pedals or emergency brake!**

Re-Install any panels that were removed to gain access to key switch in reverse order they were removed. ENJOY!

If you have any installation questions or problems, call for tech support 520.579.1531

Copyright 2024 Kleinn Automotive Accessories