



Installation Guide

RSRAM4G

Ram 1500/2500/3500/4500/5500 (Gas) 2010-2012

* For automatic transmission vehicles only

You may view a high-resolution color version of this guide online at <http://install.kleinn.com/RSRAM4G> or by scanning this QR code.



-This remote start will monitor the vehicle lock circuit and use the pulses generated by pressing lock 3 times on your OEM remote to start the vehicle.

-This is a pre-wired plug and play kit. No wire connections are required in to the truck for basic installation. For 2011 and 2012 Ram, no wire connections are required at all. 2010 Ram requires one connection within the T-harness.

-We have already loaded the correct software into the remote start module. You will need to pair the module to your key when the installation is complete. Instructions begin on page 6.

Tip #1 – Where Everything Goes

Remote Start Module – the wiring for the module is done under the dash on the driver's side, so you'll want to install the module in that general area. Before you start wiring, look for a location where there's some open space that will fit the module. Pay attention to moving parts like the pedals, e-brake and steering column. Be sure to route your wiring away from those areas.

STEP 1: Prepare the Vehicle

The bulk of the installation takes place right under the dash on the driver's side. Locate the immobilizer connector at the bottom of the key cylinder (see pictures below). Carefully disconnect the connector and insert the male plug from the T-harness in its place. Then plug the vehicle immobilizer connector in to the T-harness female connector. **Caution: Be careful when disconnecting the harness from the immobilizer connector in the vehicle. It is very fragile and will break if too much force is used. Kleinn is not responsible for any damage caused by improper removal of the connector.**

*Some vehicles will have the ignition switch mounted on the steering column, while others will have the ignition switch located on the dash. For vehicles with the ignition switch located on the steering column, remove the steering column shroud plastic to gain access to the ignition switch plug. If the ignition switch is mounted on the dash, it may be necessary to remove the radio to gain access to the key switch to the left of the radio cavity or remove the panel below the steering wheel.

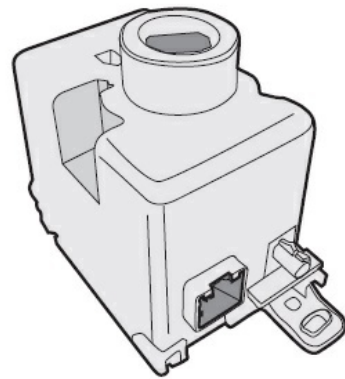

System wire diagram (2011-2012):

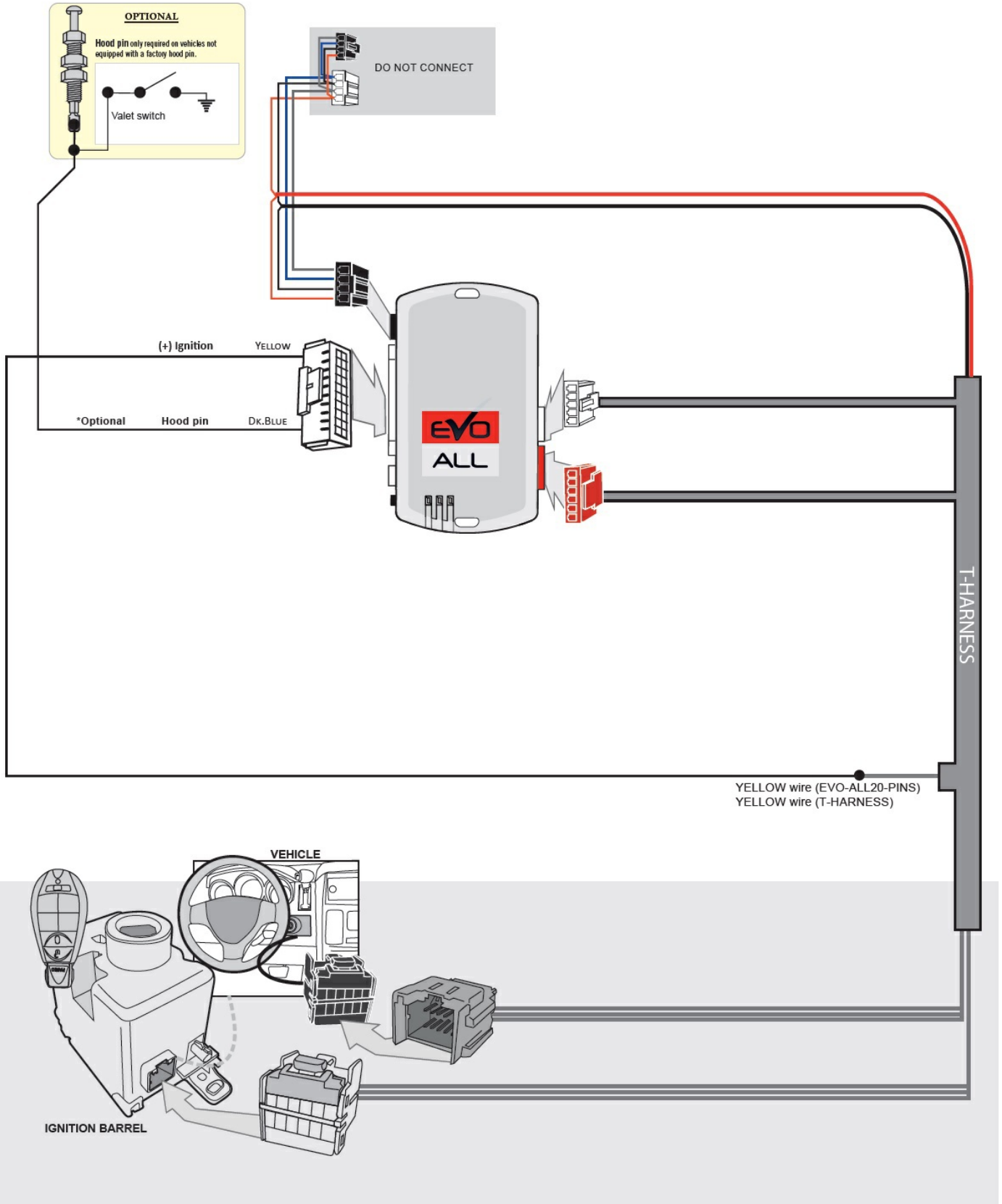

System wire diagram (2010 ONLY):

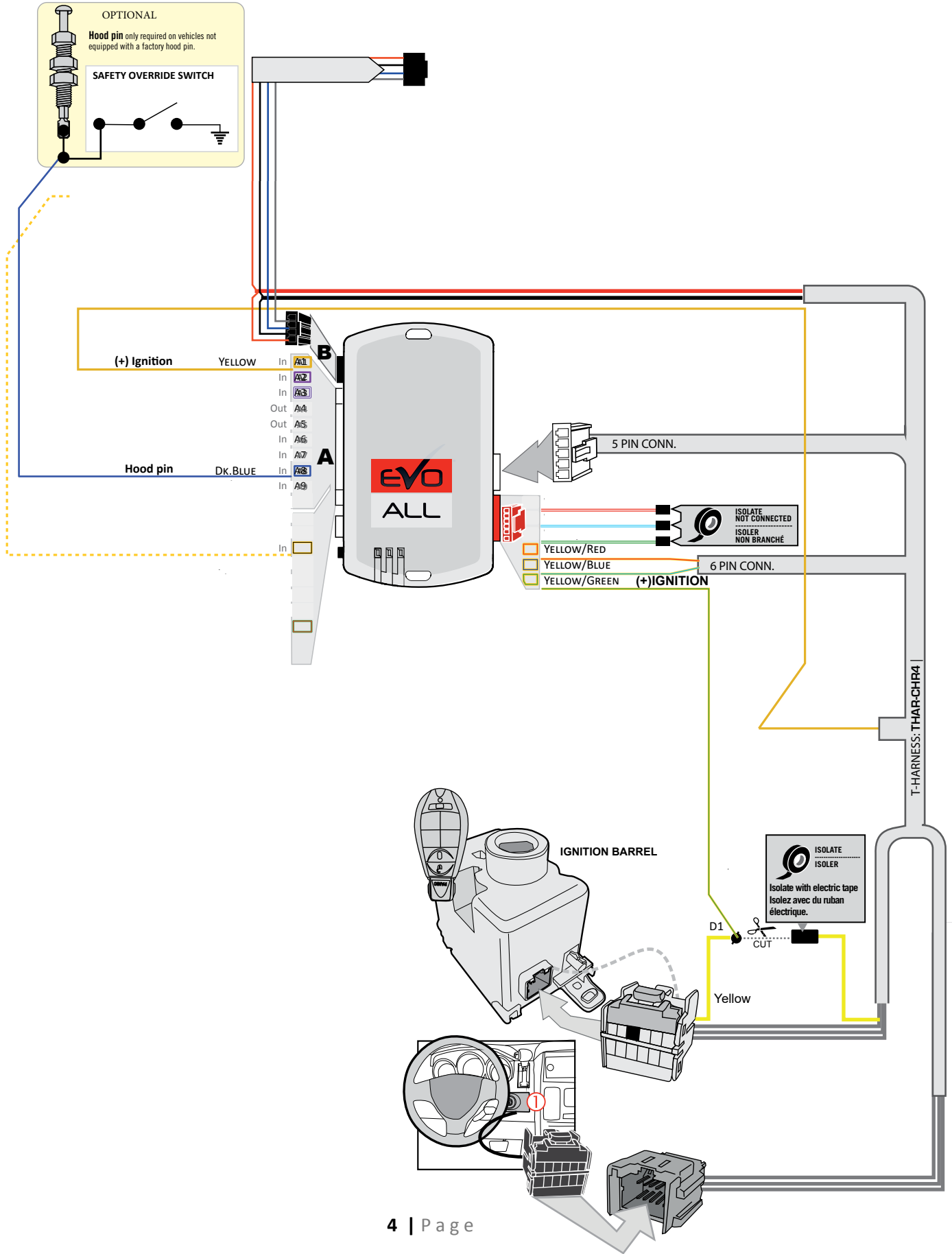

Step 2: Making the Connections

The T-Harness has several connectors that will eventually plug in to the remote start module:

- > 20-Pin White Connector
- > 5-Pin White Connector
- > 6-Pin Red Connector
- > 4-Pin Black Connector

Don't plug them in yet. That gets done during the programming process.

2010 Ram ONLY:

1. Locate the loose Yellow/Green wire on the Red 6-Pin plug.
2. Unplug the male T-Harness connector from the ignition switch assembly.
3. Locate the Yellow wire in the T-Harness that runs from the male ignition switch connector in to the wiring loom. Cut that wire close to the loom and use electrical tape to tape off the bare end.
4. Connect the side of the Yellow wire that goes to the male ignition plug to the Yellow/Green wire on the Red 6-Pin plug. See wiring diagram on Page 4.

Optional wiring connections

Hood Pin - Most vehicles come with a factory equipped hood pin switch. The hood pin is a safety feature –it prevents accidental remote starting while the hood is open and someone may be working in the engine compartment. If your vehicle is not equipped with one you can wire in the aftermarket pin switch we supplied with the kit. You will need to mount the pin switch into metal. Requires a 3/8" hole. Find a location in the engine compartment to mount the switch where the closed hood will keep the plunger in the switch depressed. This is what prevents the car from starting when the hood is open. Then route the wire to the remote start module and connect to the DarkBlue wire on the 20-pin harness. You will need to open the loom up to access this wire.

Our kits include a toggle switch which, when needed, acts as a safety feature that can disable the remote start from activating. This is a great asset which allows you to perform any engine maintenance safely while working under the hood by simply flipping the toggle switch in the other direction. If your system appears not to be working, simply check the switch as it may have been turned off. Not all kits have this feature built-in, but you can add your own. We connected this to the hood pin wire and the red LED will flash 5 times when turned on or when the hood is open.

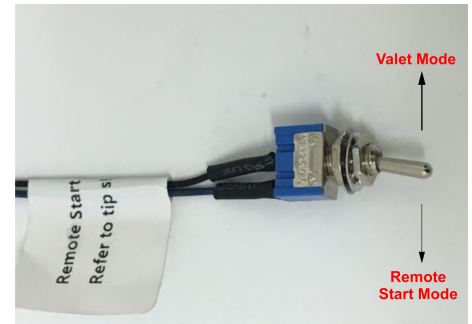

STEP 3: Programming

Once the T-harness has been plugged in to the vehicle, the remote start module is ready to be programmed. Begin with all plugs disconnected from the remote start brain, then perform the programming steps below:

1

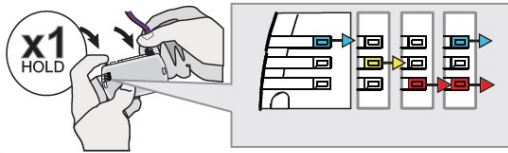

Press and hold the programming button:
Connect the 4-PIN Data-link harness (Black connector).

↳ The Blue, Red, Yellow and Blue & Red LEDs will alternatively illuminate.

2

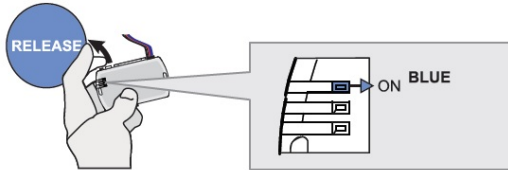

Release the programming button when the LED is BLUE.

If the LED is not solid BLUE disconnect the 4-Pin connector (Data-Link) and go back to step 1.

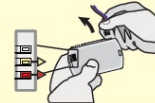

3

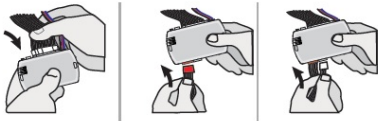

Insert the required remaining connectors.

4

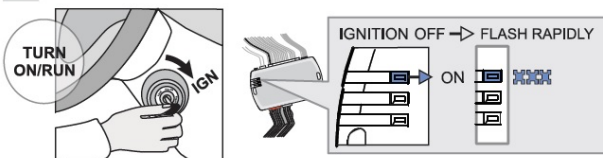

Turn the key to the Ignition ON/RUN position.

↳ The BLUE LED will flash rapidly.

5

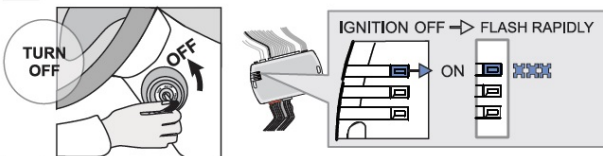

Turn the key to the OFF position.

↳ The BLUE LED will flash rapidly.

6

With OEM remote



Press the LOCK button on the vehicles OEM remote.

Or

Without OEM remote



Press and release the programming button on the module once.

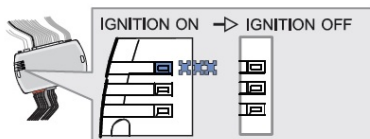

↳ The BLUE LED will turn off.



The module is now programmed.

Use the remote of the remote starter or security system to test all of the supported features to ensure proper programming.

If the Blue Led does not flash rapidly, unplug all the plugs and start over.

Step 4: Test the System

①



LOCK 3X

Press the lock button on the OEM remote three times in a row to activate the remote starter.

The vehicles ignition/accessory circuits will turn on after a few seconds. Another few seconds later the starter motor will engage. It's all about getting the timing down. Lock-1000-Lock-1000-Lock. You will see the Blue light on the remote start module every time you press the Lock button.

②



Step on the brake pedal to stop the engine.

Step 4: Close it Up

Now gather up all of your wiring and neatly bundle it together using zip ties or electrical tape. Find a secure place to put the remote start module and use zip ties to secure it. **Make sure that the remote start wires are not near any moving parts on the steering wheel, pedals or emergency brake!**

Re-Install any panels that were removed to gain access to key switch in reverse order they were removed. ENJOY!

REMOTE STARTER FUNCTIONALITY



All doors must be closed.



Remote start the vehicle.



Unlock door with remote or key and enter the vehicle.

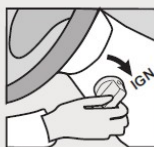

Insert the key into key switch and turn the key to the on/run position



You may now press the brake to shift into gear and drive the vehicle.

If you have any installation questions or problems, call for tech support

520.579.1531

Copyright 2020 Kleinn Automotive Accessories