

Toyota (Push to Start)										
Tacoma			16	17	18	19	20	21	22	23
Tundra							20	21		
4 Runner							20	21		
C-HR					18	19	20	21	22	
Highlander	14	15	16	17	18	19				
Highlander Hybrid	14	15	16	17	18	19				
Sequoia							20	21	22	
Land Cruiser			16	17	18					

-This remote start will monitor the vehicle lock circuit and use the pulses generated by pressing lock 3 times on your OEM remote to start the vehicle.

-This is a pre-wired kit. The ECU and Steering Lock connections are plug-in T-harness connections required for all covered vehicles.

-2016-2019 Tacoma, 2018-2019 C-HR, 2014-2019 Highlander (Gas and Hybrid), 2016-2018 Land Cruiser are plug and play.

-2020-23 Tacoma, 2020-21 Tundra, 2020-2021 4 Runner, 2020-2022 C-HR and 2020-2022 Sequoia each require two wire connections that will be detailed later in this guide.

-We have already loaded the correct firmware into the remote start module. You will need to pair the module to the vehicle when the installation is complete.

Step 1: Where Everything Goes

Remote Start Module – the wiring for the module is done under the dash on the driver's side, so you'll want to install the module in that general area. Before you start wiring, look for a location where there's some open space that will fit the module. Pay attention to moving parts like the pedals, e-brake and steering column. Be sure to route your wiring away from those areas.

- Set the parking brake and without pressing the foot brake press the push to start button twice to turn the ignition on.
- Turn the steering wheel to the right to access a screw and remove the screw.
- Turn the steering wheel to the left to access the screw on the other side and remove the screw.
Use a plastic pry tool to separate the top and bottom half of the steering column cover.
- Pull the bottom cover down to separate the two halves.
- Turn the ignition off by pressing the push to start button one time. The steering lock connector is now accessible at underside of the steering column.
- Remove the side dash panel and lower dash panel. It should be held on by a few clips.
- Once the side panel is off make sure there are not any screws holding the lower dash panel on. Most vehicles do not have any screws - the front lower dash is secured by plastic clips. Gently pull the lower plastic panel and it will come unclipped.
- You will now see the ECU on the left side of the dash.

Connecting The T-Harness

Step 2: Steering Lock plug

Locate the Steering Lock Connector on the underside of the steering column. Remove the OEM plug from the vehicle and replace it with the plug on the T-harness. Insert the OEM plug in to the female receptacle on the T-harness.

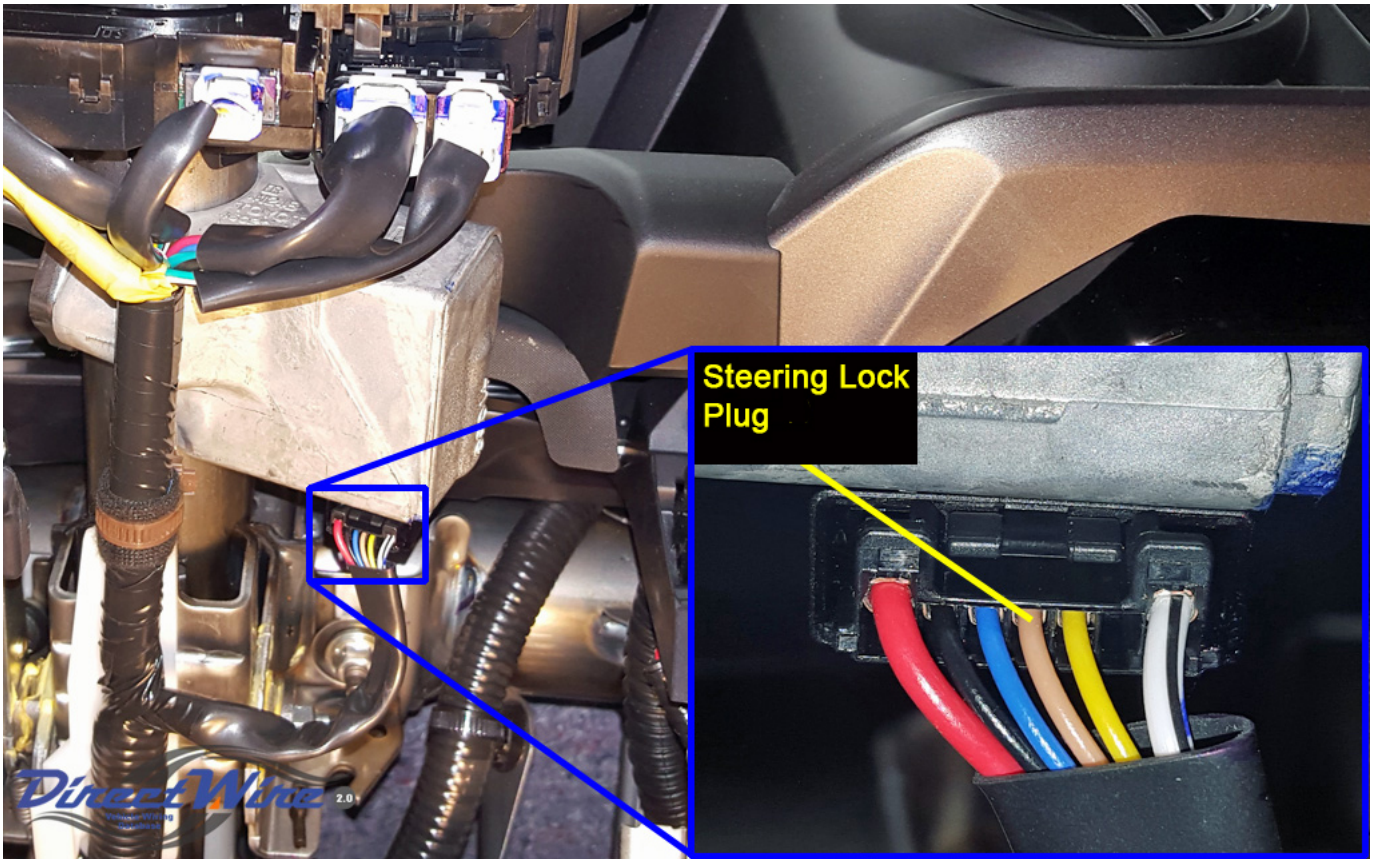

Step 3: ECU plug

The main body ECU is behind the dash on the left side. Locate the 30 pin plug on the ECU and unplug it from the ECU. Insert the male connector from the T-harness in to the vacated center position on the ECU. Insert the OEM plug in to the female receptacle on the T-harness.

- 2016-2019 Tacoma, 2018-2019 C-HR, 2020-2022 Sequoia, 2014-2019 Highlander and 2016-2018 Land Cruiser are plug & play. You can proceed to the programming steps on page 10.

- For 2020 Tacoma, 2020 Tundra, 2020-2021 4 Runner, 2020-2022 C-HR and 2020-2022 Sequoia You will need to make the telematics connections shown later in this guide on pages 5-9.

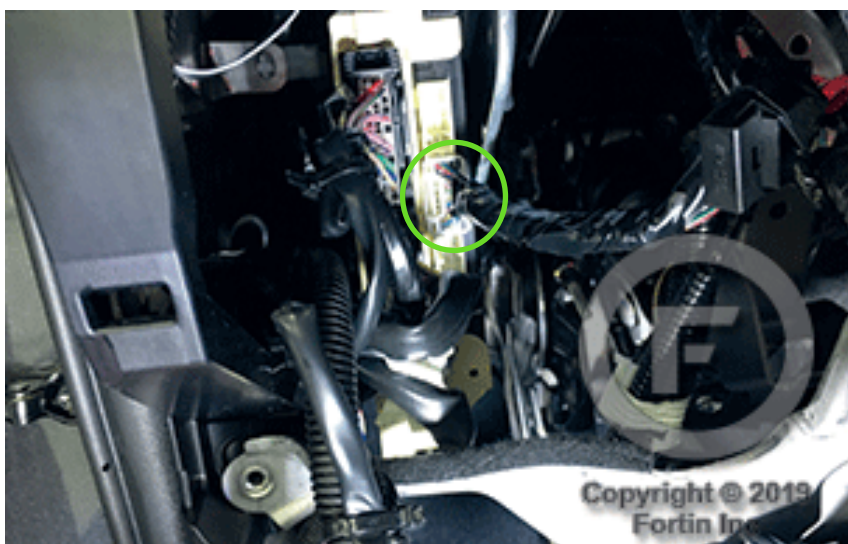

2014-2019 Highlander (Gas and Hybrid) and 2016-2018 Land Cruiser

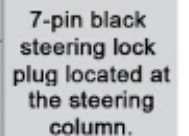

System Wiring Diagram

2020-2023 Tacoma, 2020-2021 Tundra, 2020-2021 4 Runner, 2020-2022 C-HR, 2020-2022 Sequoia

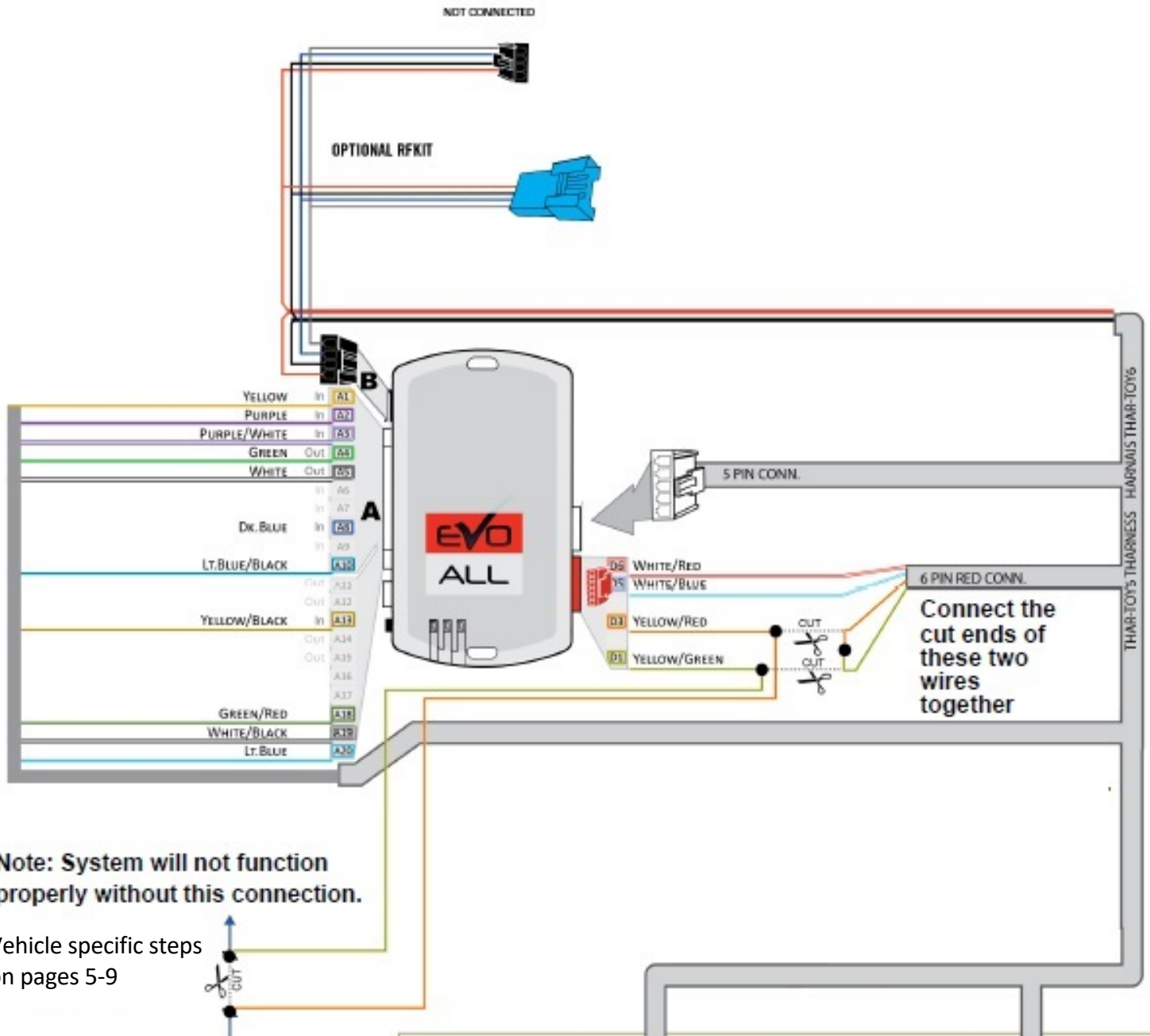

Note: System will not function properly without this connection.

Vehicle specific steps on pages 5-9

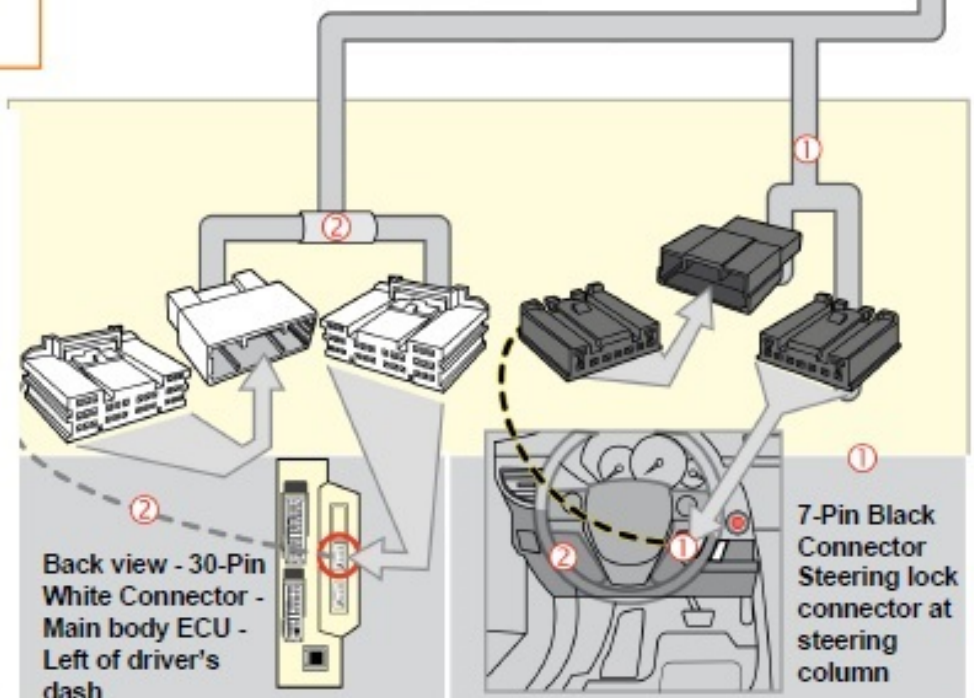

2020-2023 Tacoma ONLY - Additional Connections

1. Locate the **Red 6-pin plug** in the remote start T-Harness. Cut the **Yellow/Red & Yellow/Green** wires about half way between the red plug and where the wires enter the loom.

2. Join the two 'halves' of the wires that go in to the T-Harness loom together Shown in the image on the right pointed out with the red arrow..

3. Extend each of the wires on the plug side separately with enough wire to reach the far side of the glove box. Route the wires behind the center console and to the glove box area.

4. Now remove the glove box and locate the Telematics Module as shown below. There is a Blue wire in pin position 1 on the Telematics plug that wire needs to be cut. You will need to connect wires on to both sides of the cut, so locate your cut with as much slack wire as possible on both sides.

5. Butt connect or solder the extension of the **Yellow/Red** wire to the cut side of the Blue wire that goes to the Telematics plug.

6. Butt connect or solder the extension of the **Yellow/Green** wire to the cut side of the Blue wire that goes into the vehicle wiring.

7. Proceed to programming. See Page 10.

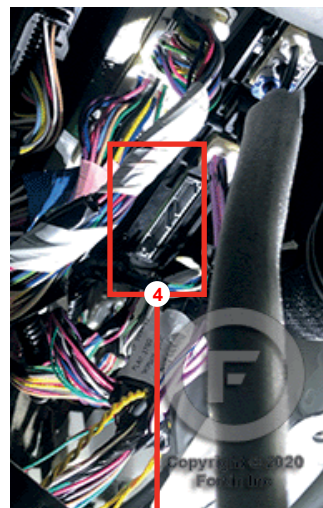
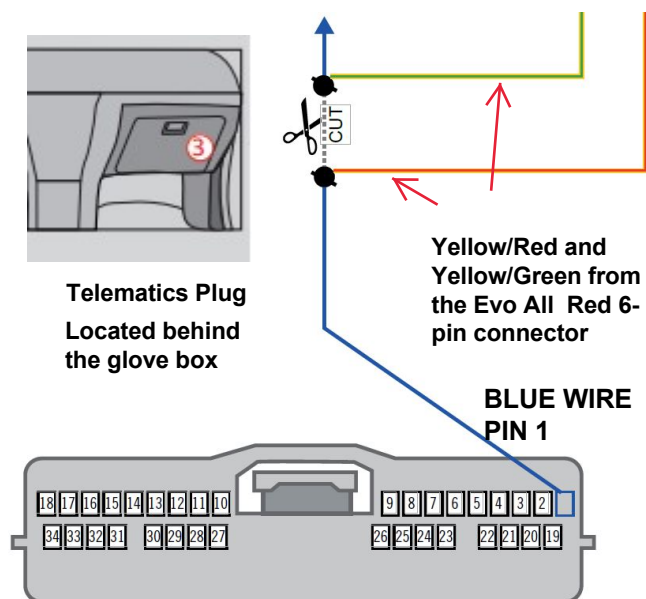
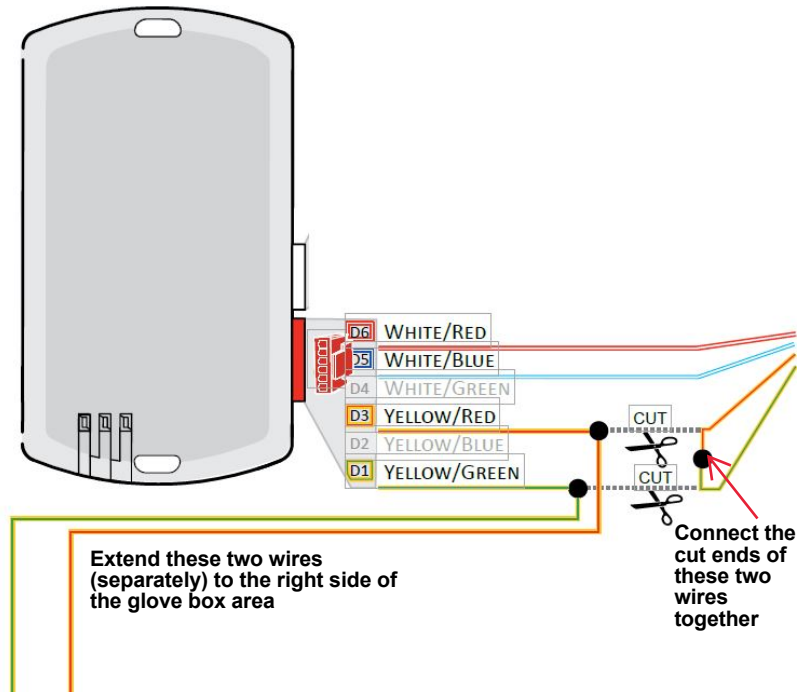

2020-2021 Tundra ONLY - Additional Connections

1. Locate the **Red 6-pin plug** in the remote start T-Harness. Cut the **Yellow/Red & Yellow/Green** wires about half way between the red plug and where the wires enter the loom.
2. Join the two 'halves' of the wires that go in to the T-Harness loom together Shown in the image on the right pointed out with the red arrow..
3. Extend each of the wires on the plug side separately with enough wire to reach the dash fuse box . Route the wires dash fuse box area.
4. Locate the driver's side fuse box under the left side of the dash and the white 56-pin plug shown in the picture below
5. There is a Red Telematics wire in pin position 33 of the white 56 pin connector at the dash fuse box plug (3J). This wire needs to be cut. You will need to connect wires on to both sides of the cut, so locate your cut with as much slack wire as possible on both sides.
6. Butt connect or solder the **Yellow/Red wire** from the Evo Red Connector to the side of the cut Red Telematics Wire.
7. Butt connect or solder the **Yellow/Green wire** from the Evo Red Connector to the side of the cut Red Telematics Wire that goes into the vehicle wiring harness.

Proceed to programming. See Page 10.

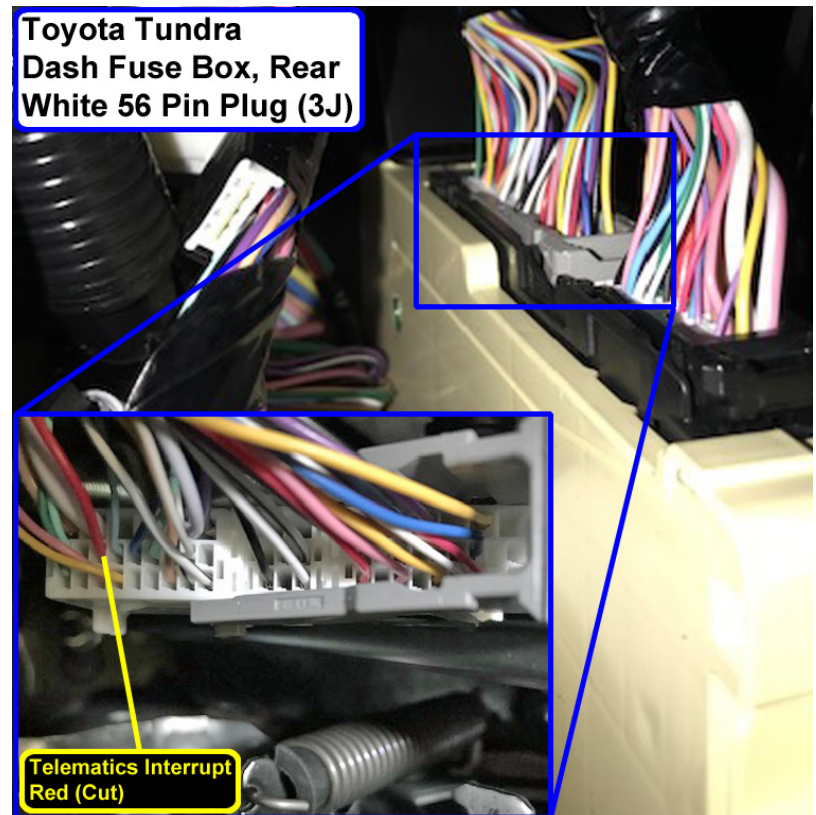
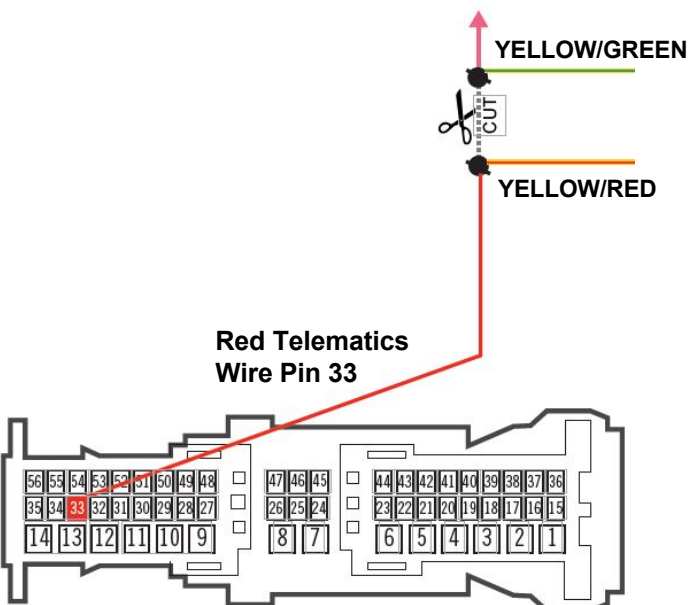
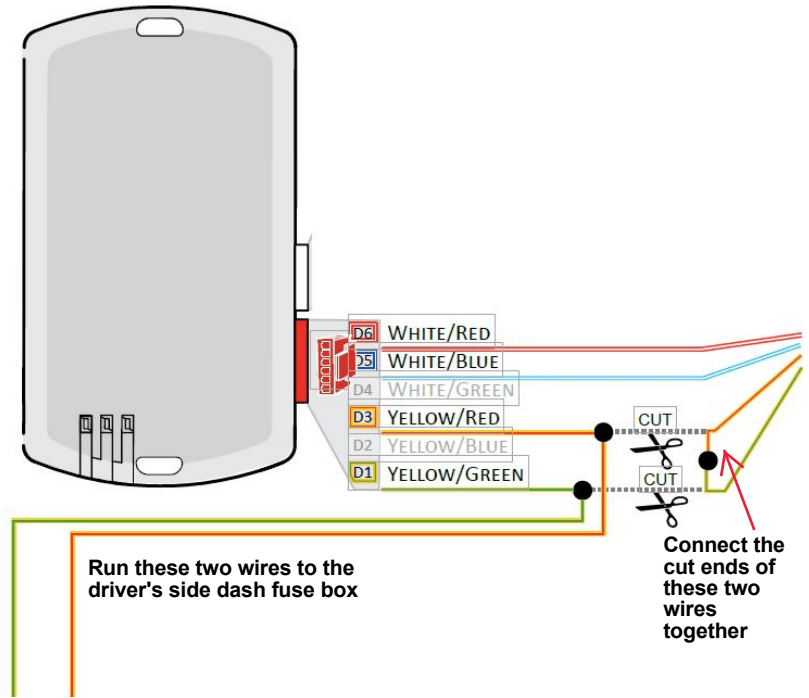

2020-2021 4 Runner ONLY - Additional Connections

1. Locate the **Red 6-pin plug** in the remote start T-Harness. Cut the **Yellow/Red & Yellow/Green** wires about half way between the red plug and where the wires enter the loom.

2. Join the two 'halves' of the wires that go in to the T-Harness loom together Shown in the image on the right pointed out with the red arrow..

3. Extend each of the wires on the EVO ALL plug side separately with enough wire to reach the dash fuse box . Route the wires dash fuse box area.

4. Locate the driver's side fuse box under the left side of the dash and the white 56-pin plug shown here.

5. There is a Pink wire in pin position 19. That wire needs to be cut. You will need to connect wires on to both sides of the cut, so locate your cut with as much slack wire as possible on both sides.

6. Butt connect or solder the Yellow/Red wire to the side of the Pink wire that goes to the Telematics plug.

7. Butt connect or solder the Yellow/Green wire to the side of the Pink wire that goes into the vehicle wiring.

Proceed to programming. See Page 10.

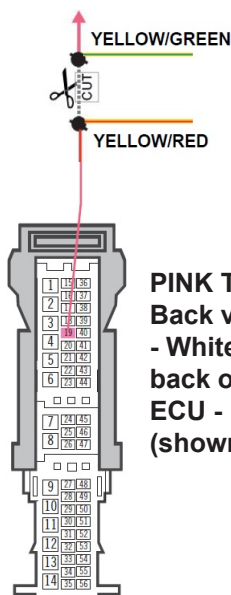

PINK TELEMATICS WIRE - PIN 19
Back view - 56-Pin
- White Connector - At the back of the MAIN BODY ECU - BELOW DASH FUSE BOX (shown in the images to the right)

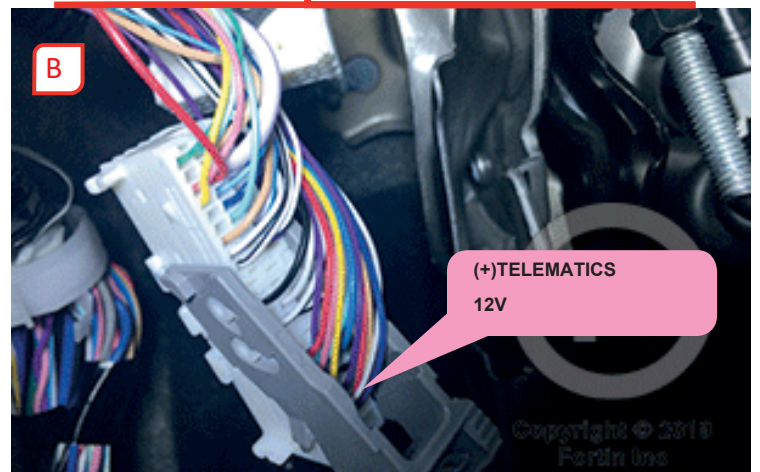
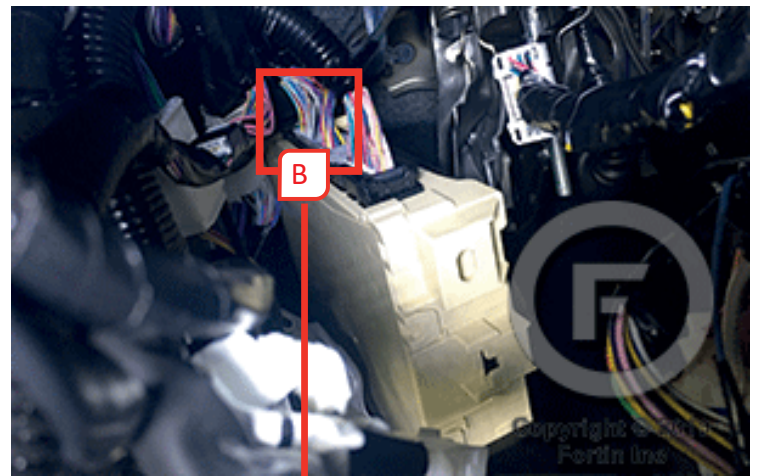
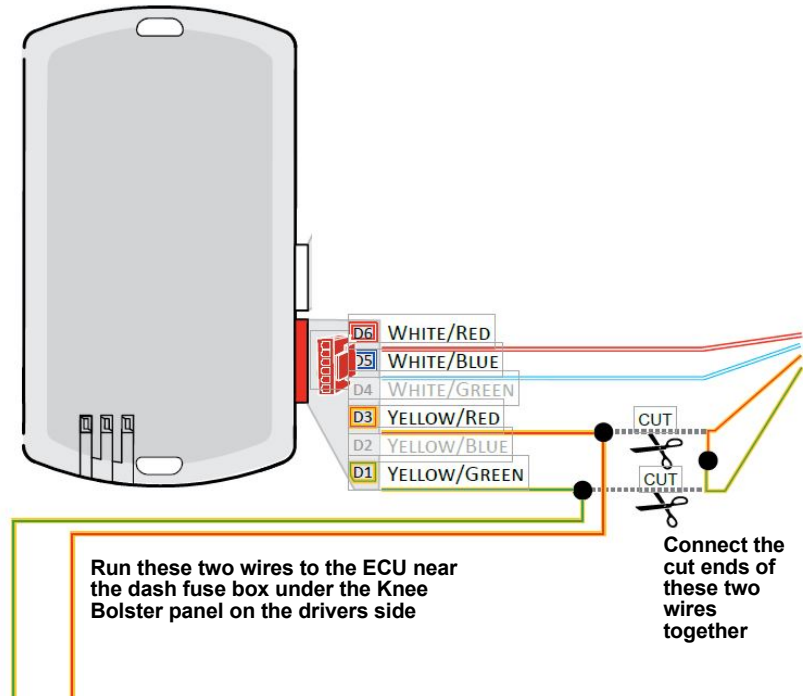

2020 -2022 C-HR ONLY - Additional Connections

1. Locate the Red 6-pin plug in the remote start T-Harness. Cut the **Yellow/Red & Yellow/Green** wires about half way between the red plug and where the wires enter the loom.
2. Join the two 'halves' of the wires that go in to the T-Harness loom together Shown in the image on the right pointed out with the red arrow.
3. Extend each of the wires on the plug side separately with enough wire to reach the passenger kick panel. Route the wires behind the center console and to the passenger side kick panel area
4. Now remove the passenger kick panel and locate the Telematics Module as shown in the photo. Locate the Red 6-pin plug in the remote start T-Harness. Cut the **Yellow/Red & Yellow/Green wires** about half way between the red plug and where the wires enter the loom.
5. Join the two 'halves' of the cut wires that go in to the T-Harness loom together Shown in the image on the right pointed out with the red arrow.
6. Butt connect or solder the **Yellow/Red** wire to the side of the **Cut TAN wire** that goes to the Telematics plug.
7. Butt connect or solder the extension of the **Yellow/Green** wire to the side of the **Cut TAN wire** that goes into the vehicle wiring.
8. Proceed to programming. See Page 10.

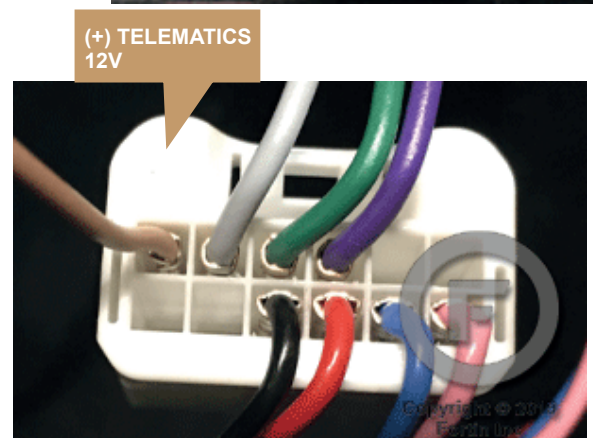
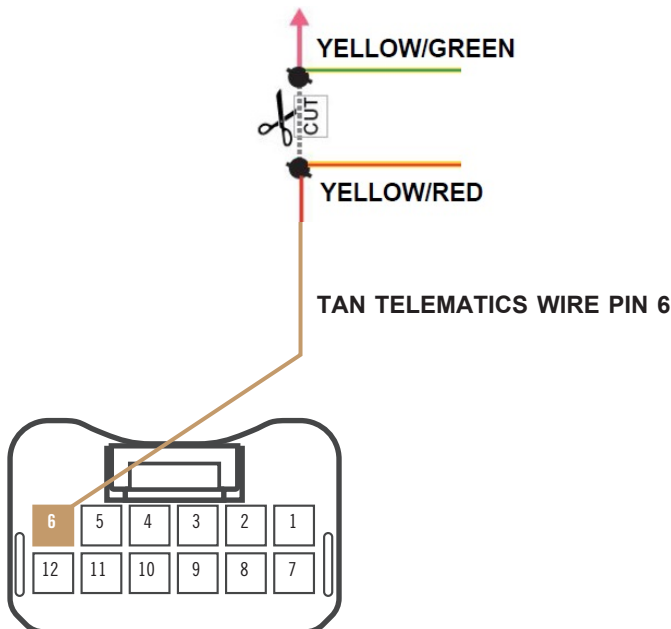
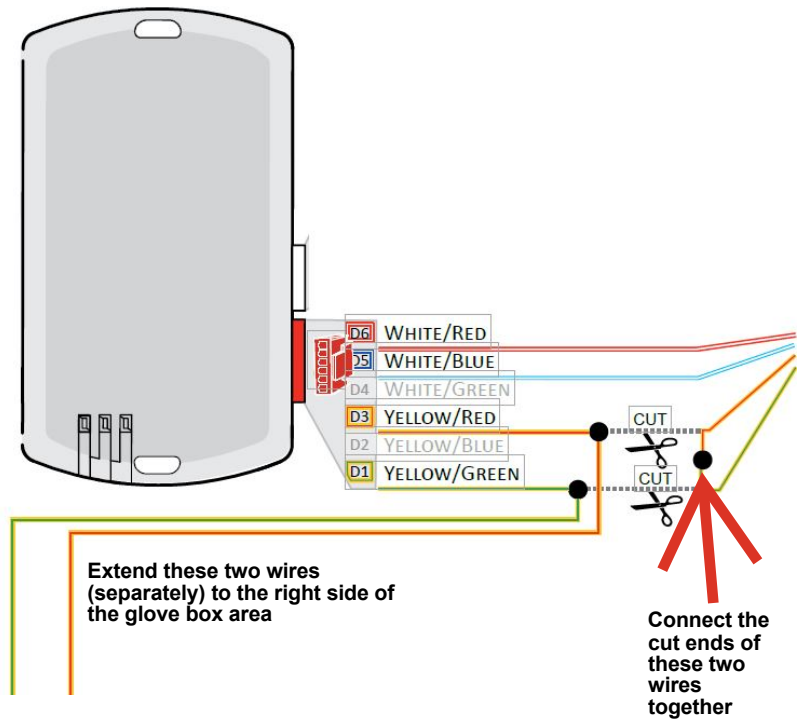

2020-2022 Sequoia ONLY - Additional Connections

1. Locate the **Red 6-pin** plug in the remote start T-Harness. Cut the **Yellow/Red & Yellow/Green wires** about half way between the red plug and where the wires enter the loom.

2. Join the two 'halves' of the cut wires that go in to the T-Harness loom together Shown in the image on the right pointed out with the red arrow.

3. Extend each of the wires on the plug side separately with enough wire to reach the rear of the dash fuse box. Route the wires to the rear of the dash fuse box.

4. Locate the driver's side fuse box under the left side of the dash and the **white 56-pin plug** shown here.

5. There is a **Violet wire in pin position 33**. That wire needs to be cut. You will need to connect wires on to both sides of the cut, so locate your cut with as much slack wire as possible on both sides.

6. Butt connect or solder the **Yellow/Red** wire to the side of the **Purple** wire that goes to the Telematics plug.

7. Butt connect or solder the Yellow/Green wire to the side of the **Purple** wire that goes into the vehicle wiring.

Proceed to programming. See Page 10.

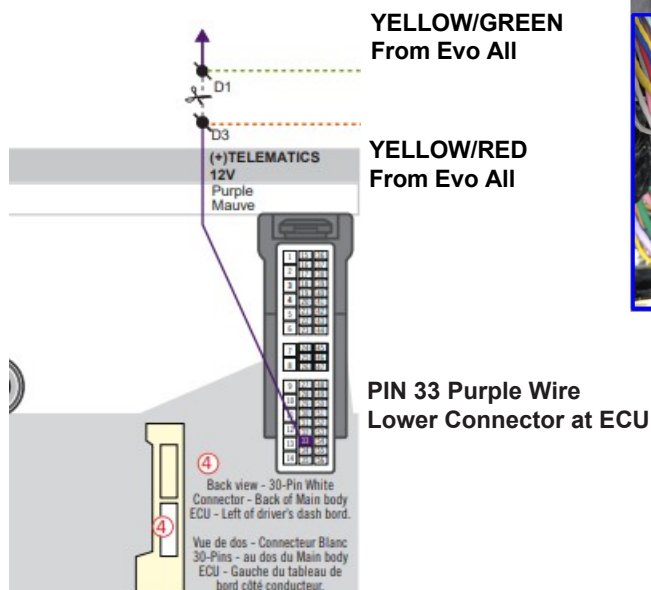
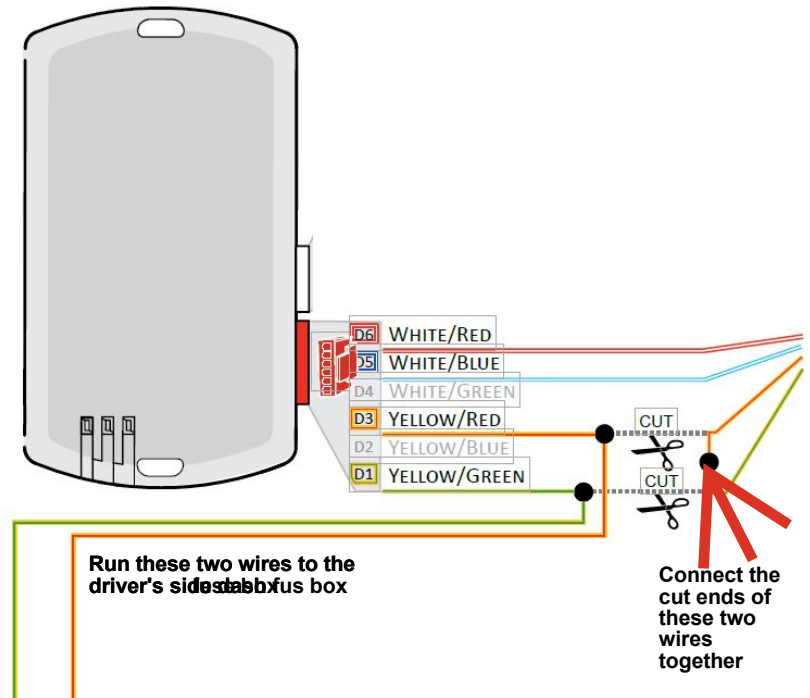

Toyota Sequoia
Dash Fuse Box
Rear White 56 Pin
Plug (3J)

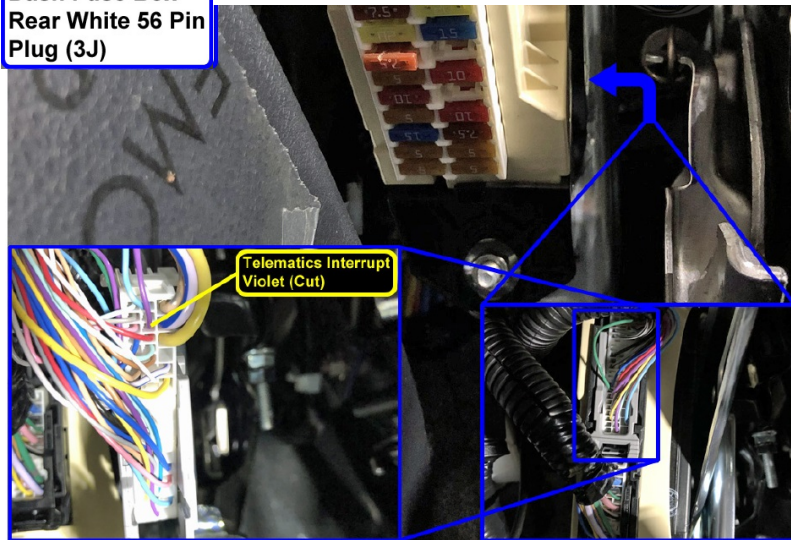

Step 4: Programming

1

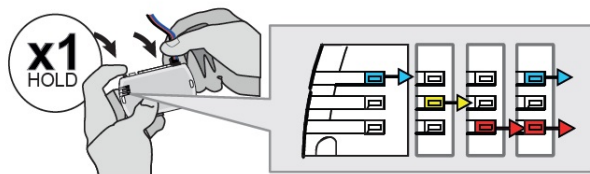

Press and hold the programming button:
Connect the 4-PIN Data-link connector.

↳ The BLUE, RED, YELLOW and BLUE & RED LEDs will alternatively illuminate.

2

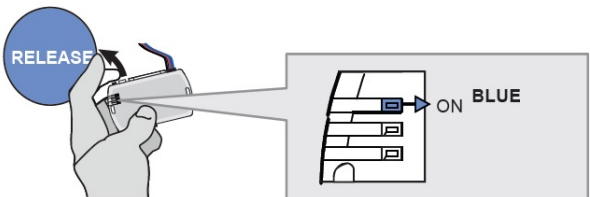

Release the programming button at the moment when the LED is BLUE.

If the LED does not remain solid BLUE after releasing the button, then **disconnect** the 4-Pin connector (Data-Link) and **go back** to step 1.

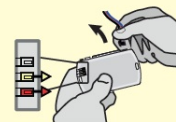

3

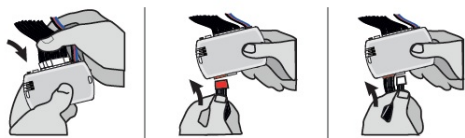

Insert the required remaining connectors.

4

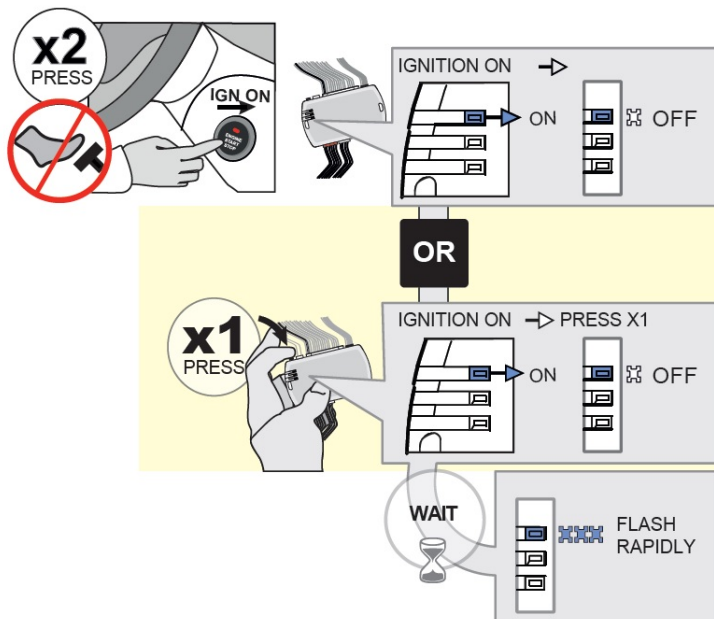

Do not press the brake pedal.
Press the Push-to-Start button twice to turn on the ignition.

↳ The BLUE LED should turn off.

If the LED remains lit solid BLUE after the ignition is turned on, then **press and release** the programming button once (1x).

↳ The BLUE LED will turn off.

After the BLUE LED turns off, then **Wait**.

↳ The BLUE LED will flash rapidly.

5

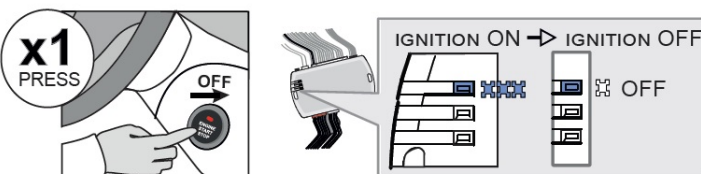

Press the Push-to-Start button once to turn off the ignition.

↳ The BLUE LED will turn off.



The module is now programmed.

Step 5: Test the System

1. Press "Lock>Lock>Lock" on your OEM remote control. You will see the Blue light on the remote start module every time you press the Lock button. Each press should be about 1 second apart. The vehicles ignition/accessory circuits will turn on after a few seconds. Another few seconds later the starter motor will engage.
2. Open the vehicle door. The remote start will shut down.

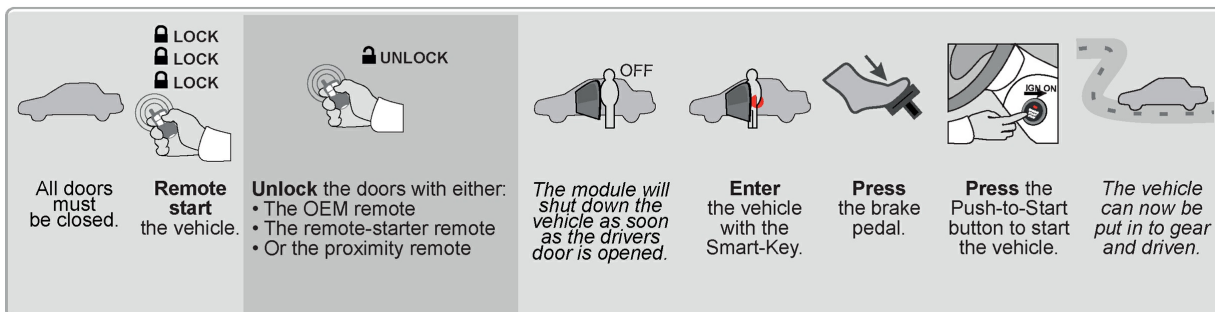

Step 6: Close it Up

Now gather up all of your wiring and neatly bundle it together using zip ties or electrical tape. Find a secure place to put the remote start module and use zip ties to secure it. **Make sure that the remote start wires are not near any moving parts on the steering wheel, pedals or emergency brake! Re-Install any panels that were removed to gain access to key switch in reverse order they were removed. Be careful not to pinch any wires. ENJOY!**

Parts List

- EVO-ALL Remote Start Data Module
- THAR-TOY6B T-Harness

If you have any installation questions or problems, call for tech support
520.579.1531