

Jeep

Wrangler	07	08	09	10	11	12	13	14	15	16	17	18
----------	----	----	----	----	----	----	----	----	----	----	----	----

- This remote start will use 1-button remotes to start/stop & lock/unlock the vehicle.
- This is a pre-wired plug and play kit and all the required connections have been made within the harness.
- We have already loaded the correct firmware into the remote start module. You will need to pair the module to your key when the installation is complete. Instructions begin on page 4.

Overview

There are 6 basic steps to this remote start installation. We're going to address each of these:

1. Prepare the vehicle
2. Make your wiring connections
3. Pair the remote start to the vehicle
4. Pair the remotes to the remote starter
5. Test the system
6. Button it up!

-Where Everything Goes

Remote Start Module – the wiring for the module is done under the dash on the driver's side, so you'll want to install the module in that general area. Before you start wiring, look for a location where there's some open space that will fit the module. Pay attention to moving parts like the pedals, e-brake and steering column. Be sure to route your wiring away from those areas.

STEP 1: Prepare the Vehicle

Begin by removing the plastic shroud below the steering wheel and then the plastic around the steering wheel column. Remove the three screws and loosen the tilt lever and pull lower plastic panel down. Be careful not to break the panel –especially in cold weather.

Step 2: Make the Connections

The T-Harness will have some plugs on the other end. This is what you do with them:

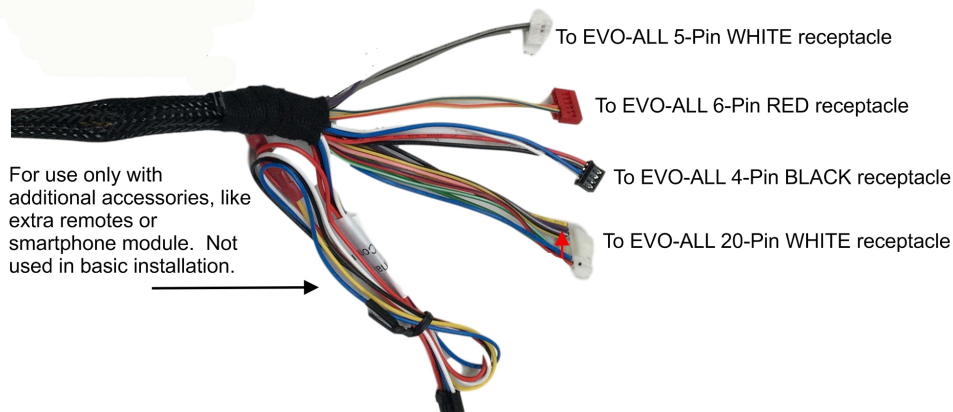

- Locate the RFA2A adapter included with your remote kit T-harness.
- Plug the black 4-pin connector from your T-harness into the black female connector of the the RFA2A adapter.
- Plug the blue 4-pin connector from the RF kit antenna into the blue female connector of the the RFA2A adapter.

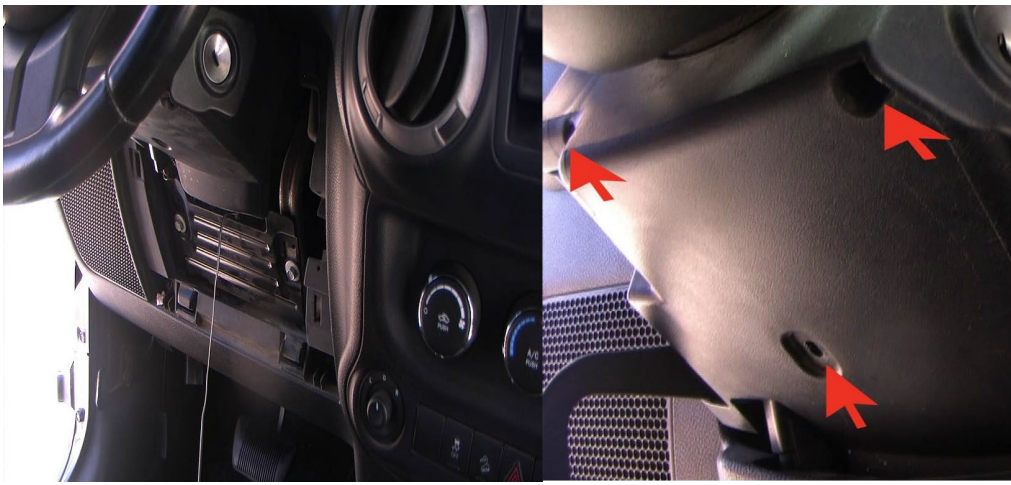

Production Change Mid 2016:

Some 2016 and all 2017 models have a lip that goes under the steering wheel. You must push the panel forward to remove it. Use a plastic scraper or pry tool to wedge in between the steering wheel and the steering wheel cover to get the lip around the corner so you can pull it down and remove it without removing the steering wheel. See below.



Locate the immobilizer connector at the bottom of the key cylinder (see pictures below). Carefully disconnect the connector and insert the male plug from the T-harness in its place. Then plug the vehicle immobilizer connector in to the T-harness female connector. **Caution: Be careful when disconnecting the harness from the immobilizer connector in the vehicle. It is very fragile and will break if too much force is used. Kleinn is not responsible for any damage caused by improper removal of the connector.**

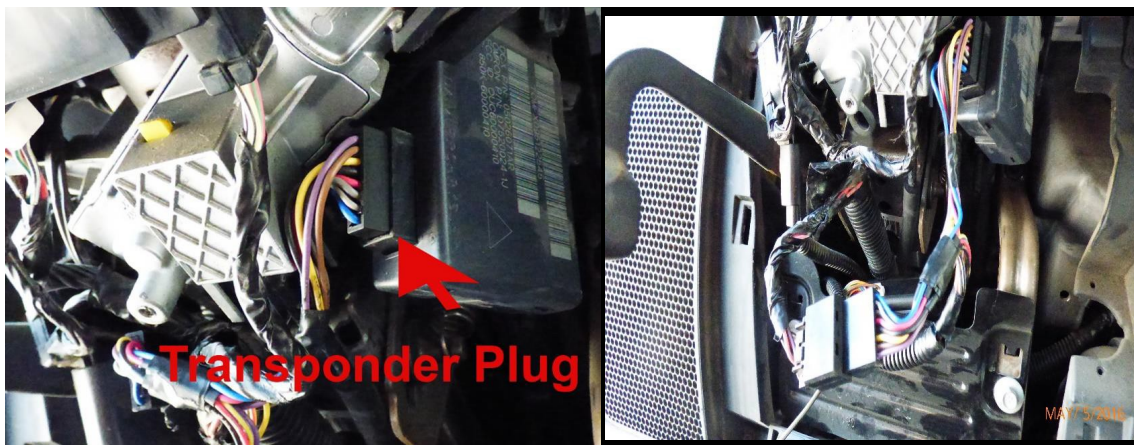

System Wiring Diagram

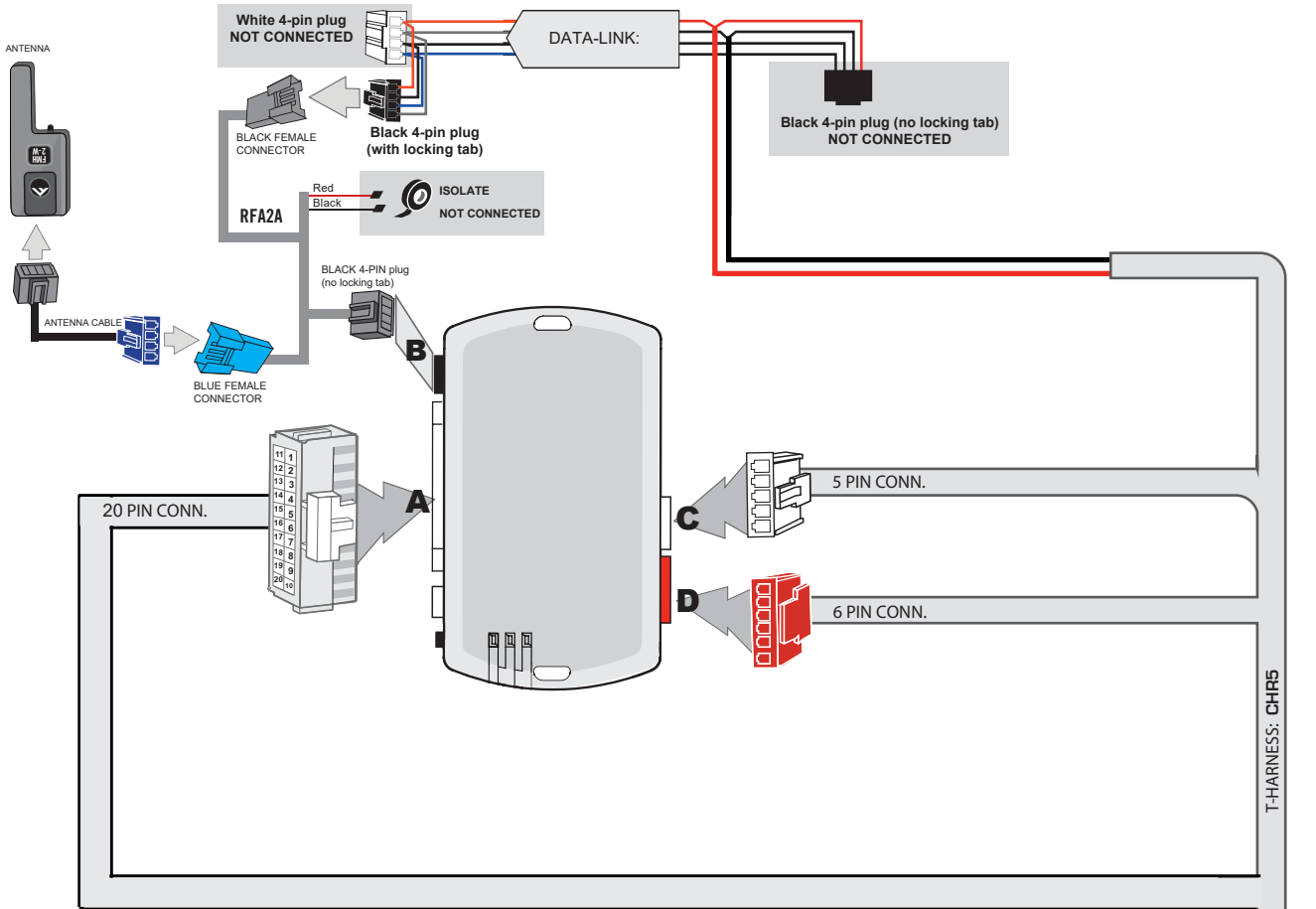

Wrangler

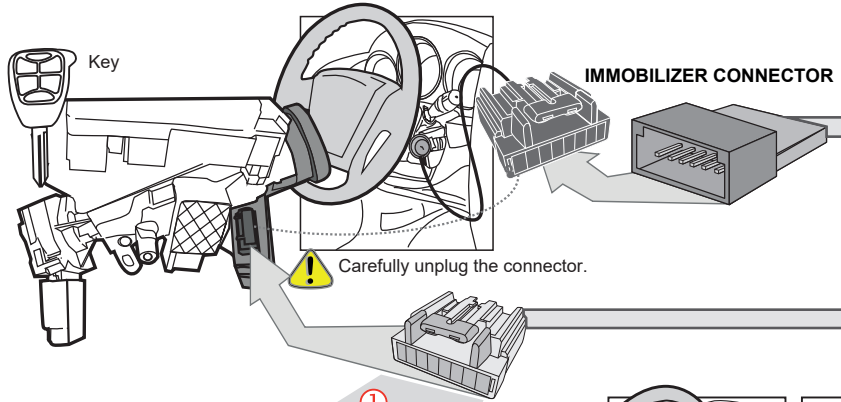

Vehicle transponder connector
Back view

CAUTION
TAKE CARE WHEN DISCONNECTING THE HARNESS FROM THE IMMOBILIZER CONNECTOR. IT IS VERY FRAGILE AND CAN EASILY BREAK.

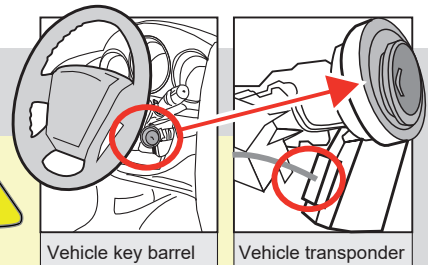

STEP 3: Programming

Once the T-harness has been plugged in to the vehicle, the remote start module is ready to be programmed. Begin with all plugs disconnected from the remote start brain, then perform the programming steps below:

1

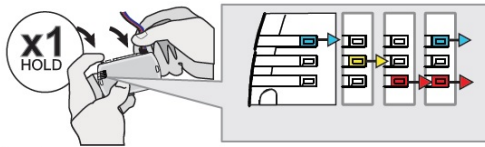

Press and hold the programming button:
Connect the 4-PIN Data-link harness (Black connector).

↳ The Blue, Red, Yellow and Blue & Red LEDs will alternatively illuminate.

2

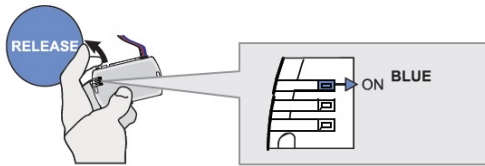

Release the programming button when the LED is BLUE.

If the LED is not solid BLUE disconnect the 4-Pin connector (Data-Link) and go back to step 1.

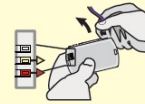

3

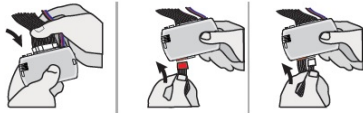

Insert the required remaining connectors.

4

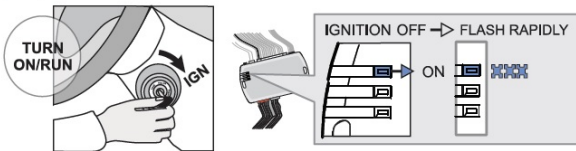

Turn the key to the Ignition ON/RUN position.

↳ The BLUE LED will flash rapidly.

5

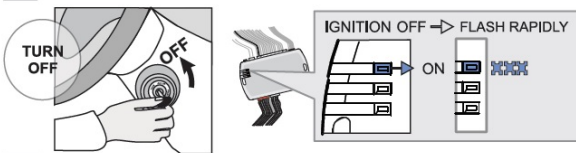

Turn the key to the OFF position.

↳ The BLUE LED will flash rapidly.

6

With OEM remote



Press the LOCK button on the vehicles OEM remote.

Or

Without OEM remote



Press and release the programming button on the module once.

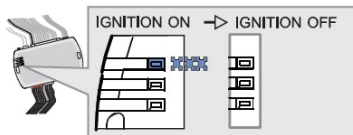

↳ The BLUE LED will turn off.



The module is now programmed.

Use the remote of the remote starter or security system to test all of the supported features to ensure proper programming.

Step 4: Pair the remotes to the remote starter

PROGRAMMING REMOTE TRANSMITTER(S)

1

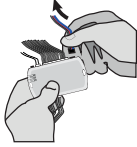

Unplug the 4 Pin (Data-Link) connector from the EVO module.

2

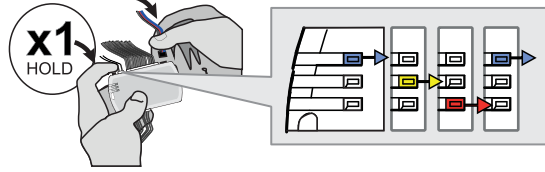

Press and hold the programming button:
Reinsert the 4-Pin (Data-Link) connector.

3

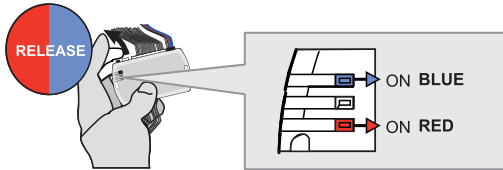

Release the programming button when LEDs are BLUE & RED.

If the LED are not solid BLUE and RED disconnect the 4-Pin connector (Data-Link) and go back to step 1.

4

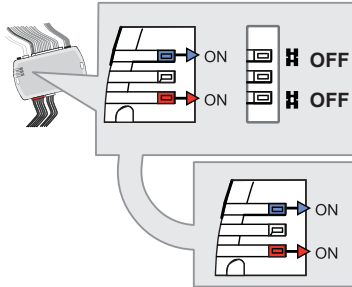

Press and hold the programming button until the Blue and RED LED turn back ON.

The Blue and Red LED will go Off and back On.

5

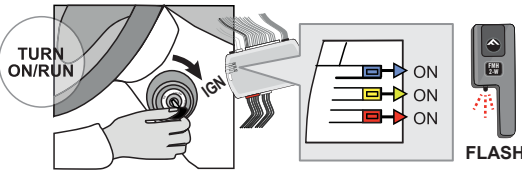

Turn the key to the ON/RUN position.

The Blue, Yellow and Red LEDs will turn On.
The antenna will flash rapidly.

6

RM411



On each Transmitter
Press and **HOLD** the  for **12 SECONDS** and **WAIT** for the LED to **TURN ON SOLID** then **release**.

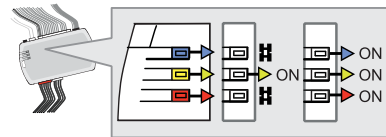

The Blue and Red LEDs will flash once everytime to confirm.

7

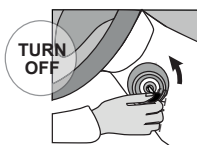

Turn the Ignition to the OFF position and test the installation.

The remote is now programmed.

Step 5: Test the System

Once all wiring and programming are done, you should test the system to make sure everything is working properly before you close up the installation.

USING THE REMOTE CONTROL

RM411	press	seconds	COMMAND	DESCRIPTION
	1x	0.5 seconds	LOCK	Press the button 1x (0.5 seconds) : Locks all doors, arm the anti-theft system and activates the Alarm (if installed).
	2x	0.5 seconds	UNLOCK	Press the button 2x (0.5 seconds): Unlocks all doors, disarms the anti-theft system and deactivates the Alarm (if installed).
	1x	3 seconds	START OR STOP	Press and hold the button for 3 seconds: Remote-start the vehicle. If the engine is ON : the engine will turn OFF. *

*



Stepping on the brake pedal will also shut down the remote starter.

REMOTE STARTER FUNCTIONALITY



All doors must be closed.



Remote start the vehicle.



Unlock door with remote or key and enter the vehicle.

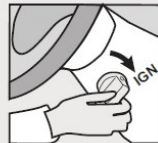

Insert the key into key switch and turn the key to the on/run position



You may now press the brake to shift into gear and drive the vehicle.

Step 6: Close it Up

Now gather up all of your wiring and neatly bundle it together using zip ties or electrical tape. Find a secure place to put the remote start module and use zip ties to secure it. **Make sure that the remote start wires are not near any moving parts on the steering wheel, pedals or emergency brake!**

Re-Install any panels that were removed to gain access to key switch in reverse order they were removed. ENJOY!

If you have any installation questions or problems, call for tech support

520.579.1531

Copyright 2024 Kleinn Automotive Accessories